



- **EFM-230**

**FEATURES:**

- High output
- Low current drain
- Wide voltage range

DIMENSIONS: (Unit: mm)

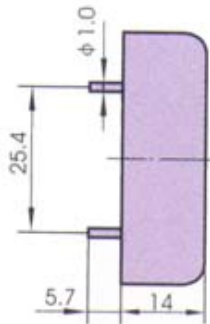
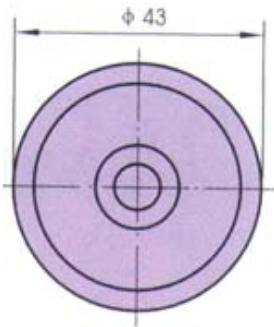
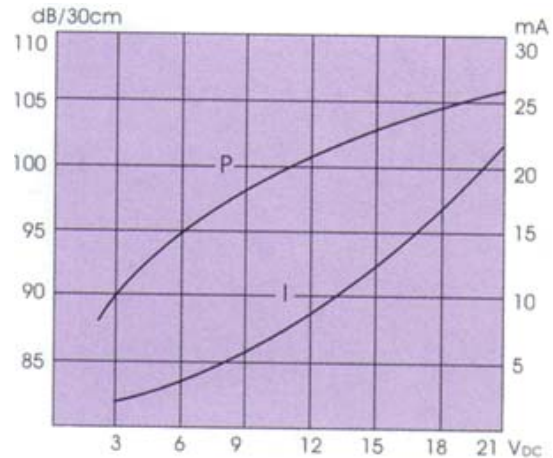
**CHARACTERISTICS:****ELECTRICAL SPECIFICATIONS :**

Model No.	EFM-230
Min. Sound Pressure Level (dB)	100 /12V _{DC} /30cm
Rated Voltage (V _{DC})	12
Operating Voltage (V _{DC})	3 ~ 20
Max. Consumption (mA)	15 /12V _{DC}
Oscillating Frequency (kHz)	2.9 ± 0.5
Tone Nature	Continuous
Operating Temperature (°C)	-20 ~ +70
Weight (g)	10.6
Case Material/Colour	ABS/Black

PACKING INFORMATION :

Packing :	500 pcs per export carton
Carton Size :	47 X 30.5 X 25 cm
G. Weight :	8.3 kgs
N. Weight :	5.5 kgs